

1

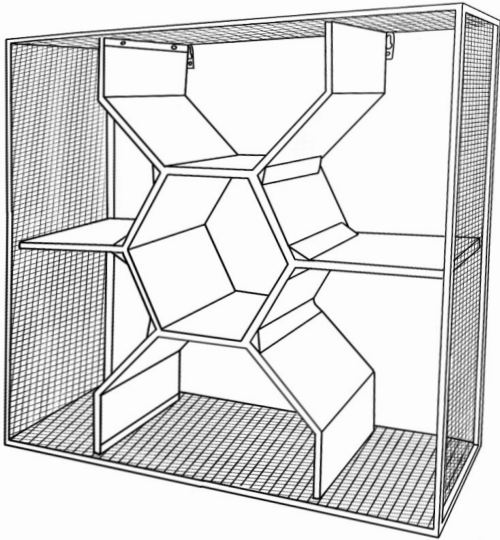

### UNPACK SHELF

Carefully take shelving unit out of its package. Make pencil marks on the wall where the keyholes are.

2

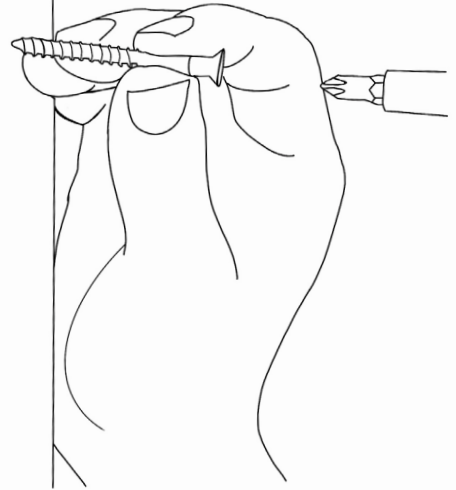

### GATHER (2) LONG SCREWS

and drill them into the wall where you made your pencil marks. Place shelf on screws.

3

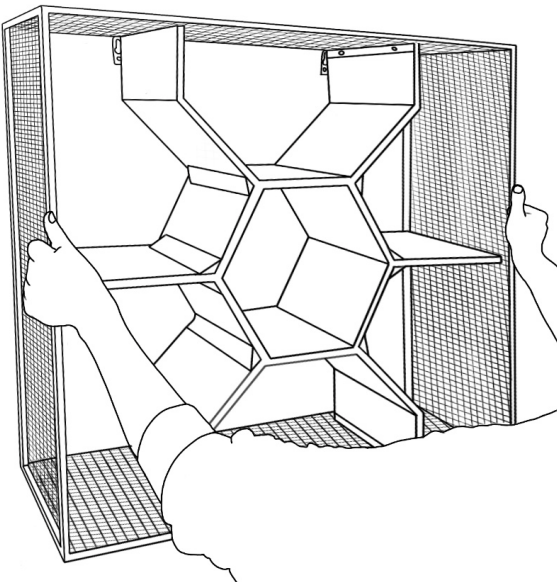

### CAREFULLY PULL SHELF

down so the screw heads slip into the narrow part of the keyholes, thus locking the shelf in place.

4

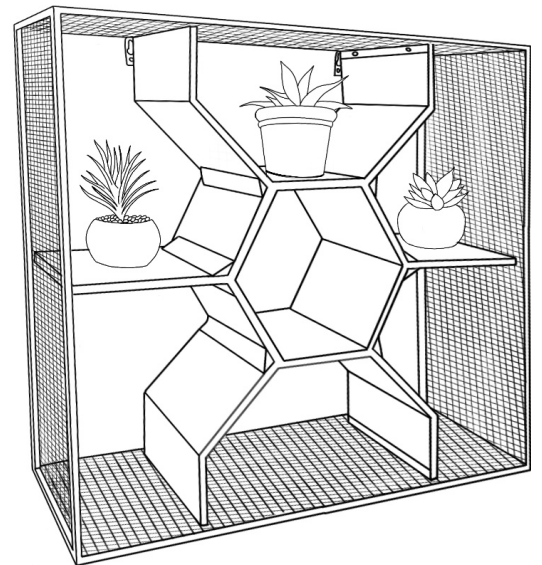

### STYLE YOUR SHELF

with your favorite accessories!